

NOTES:  
 1. MATERIAL: SLS NYLON 12 GF

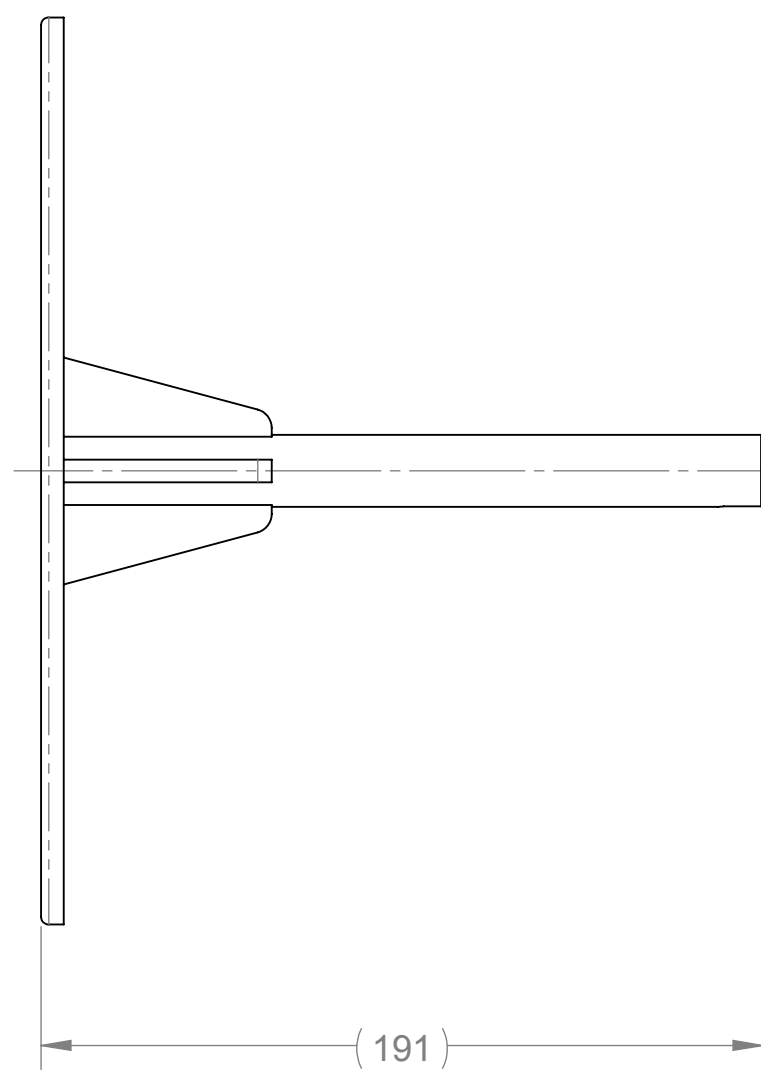

SURFACE FINISH MUST MEET SPECIFICATION IN THIS AREA BUT MAY EXTEND BEYOND

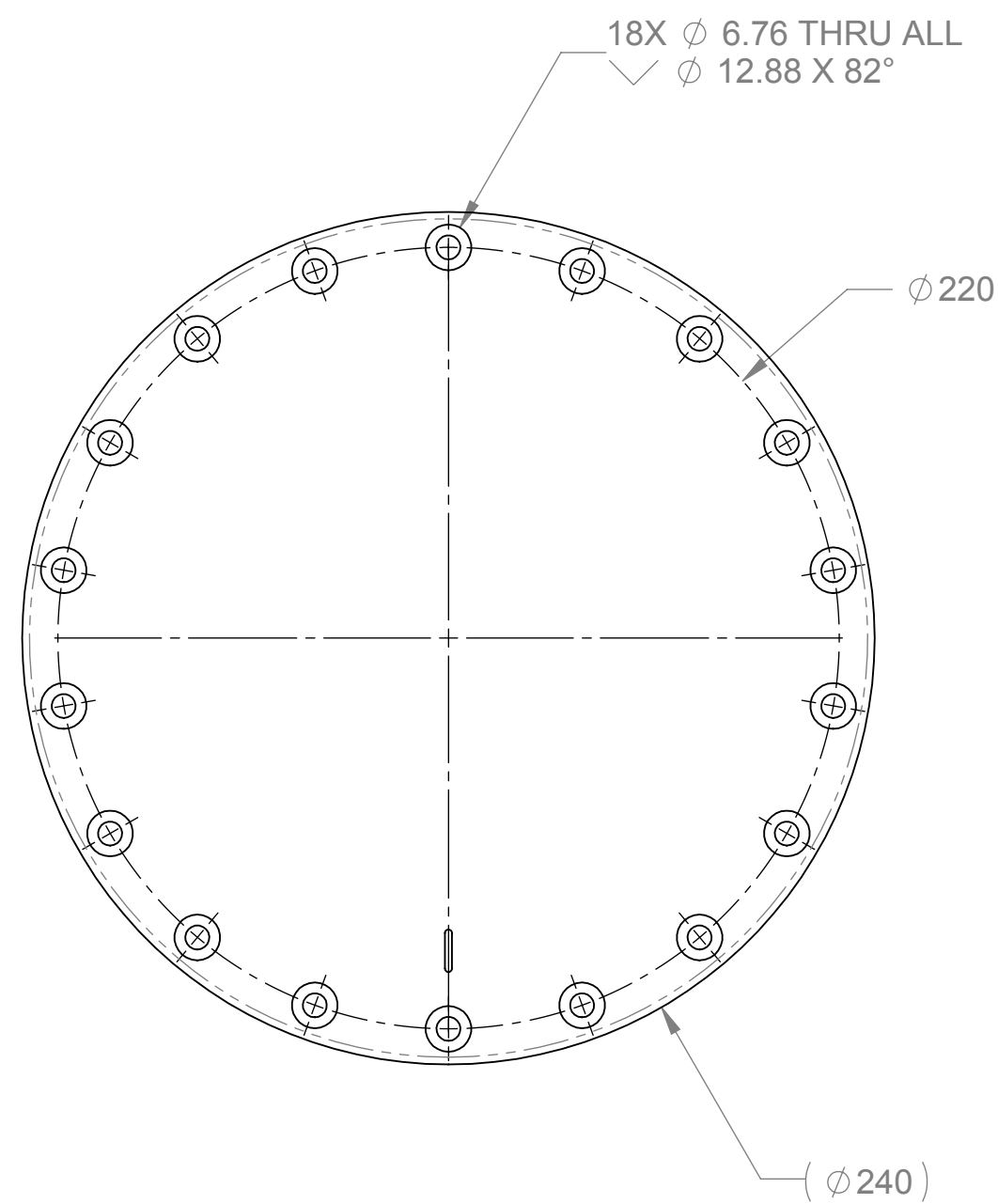
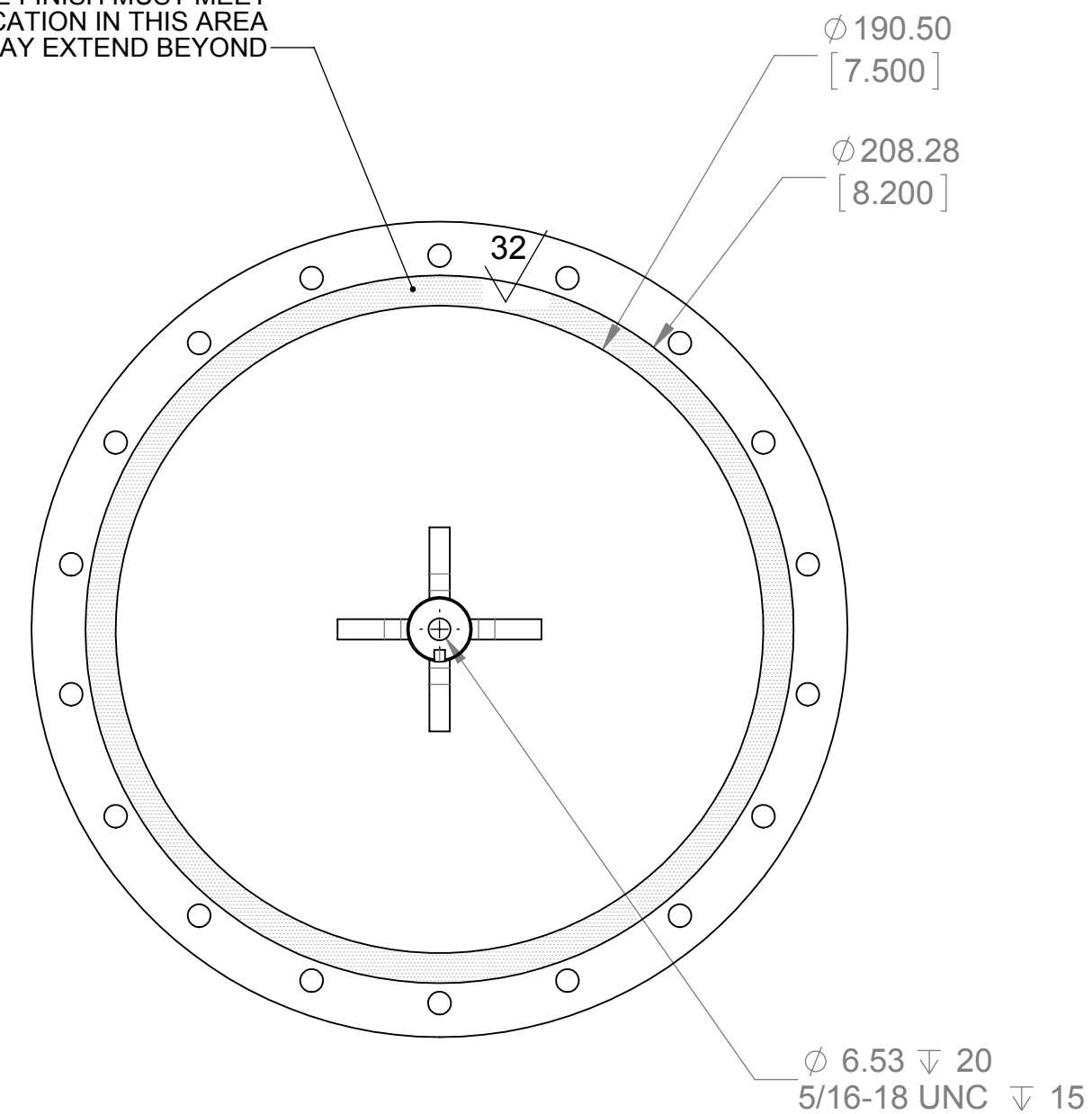

CONFIDENTIAL

MATERIAL RESTRICTIONS: ALL PARTS AND ASSEMBLIES SUPPLIED TO THIS SPECIFICATION SHALL BE IN FULL COMPLIANCE WITH SM-0564 - MATERIAL PROHIBITIONS AND RESTRICTIONS.		THIS DOCUMENT CONTAINS PROPRIETARY DATA OF HOLOGIC INC. NO DISCLOSURE, REPRODUCTION, OR USE OF ANY PART THEREOF MAY BE MADE EXCEPT BY WRITTEN PERMISSION FROM HOLOGIC.		<b>HOLOGIC</b> <small>SENTINELLE MEDICAL        A DIVISION OF HOLOGIC        555 RICHMOND STREET WEST        TORONTO, ON        M5V 3B1</small>	
<b>UNLESS OTHERWISE SPECIFIED</b> <small>DO NOT SCALE DRAWING        INTERPRET IN ACCORDANCE WITH ASME Y14.5M-2009        DIMENSIONS ARE IN mm        TOLERANCES APPLY AS SHOWN BELOW</small>		<b>PROPOSED</b>		<b>LID PHANTOM PROSTATE EXTERNAL BIG</b>	
<small>0-10 ± 0.1        10-50 ± 0.2        50-100 ± 0.3        100-300 ± 0.4        300-1000 ± 0.5        ANGLES ± 5°        SURFACE ROUGHNESS 0.8 <math>\mu</math>m</small>		<small>NAME DATE</small> ENGINEER: J. JANKOWSKI N/A		<small>PART/ASSEMBLY NUMBER:</small> XXX-YYYYY	
<small>THIRD ANGLE PROJECTION</small>		<small>AUTHOR BY: J. JANKOWSKI 28FEB2013</small> <small>DRAFTED BY: J. JANKOWSKI 28FEB2013</small> <small>REVISION RELEASE DATE</small>		<small>SIZE C DRAWING NUMBER: RR-XXXXX</small> <small>SCALE 1:2 MODEL FILENAME: lid phantom prostate external big 00</small>	
				<small>SHEET 1 OF 1</small>	